

Technical Program

ACMBS-V 2008

**The 5th International Conference
on Advanced Composite Materials
in Bridges and Structures**

Official Conference of:

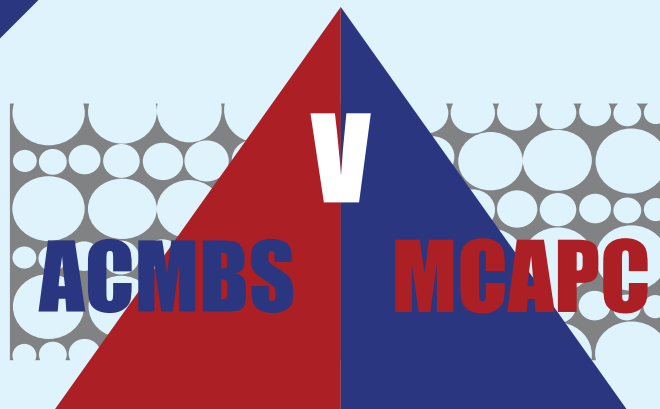

**22-24 September 2008
Fairmont Hotel
Winnipeg, Manitoba, Canada**

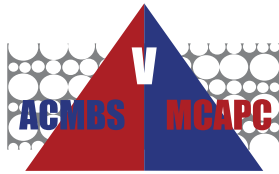

The 5th International Conference on
ADVANCED COMPOSITE MATERIALS IN BRIDGES AND STRUCTURES
MATÉRIAUX COMPOSITES D'AVANT-GARDE POUR PONTS ET CHARPENTES

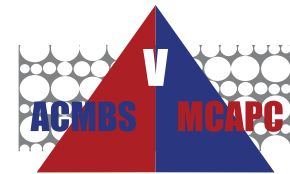

SPONSORED BY:



www.csce.ca

The CSCE is a learned society intended to develop and maintain high standards of civil engineering practice in Canada and to enhance the public image of the civil engineering profession. The Canadian Society for Civil Engineering promotes the development, acquisition and exchange of professional knowledge in the field of Civil Engineering. Supportive of the work of academics and private institutions and different organizations that deal with Civil Engineering since 1887 and working with sister organizations, the CSCE also promotes Civil Engineering among the general public and governmental institutions in Canada and abroad.

CONTACT INFO:

CSCE
National Office
4920 de Maisonneuve Blvd. W. Suite 201
Montréal, QC H3Z 1N1
Ph: 514.933.2634 • Fax: 514.933.3504
e-mail: info@csce.ca



ISIS CANADA RESEARCH NETWORK
A Canadian Network of Centres of Excellence

www.isiscanada.com

ISIS Canada Research Network (Intelligent Sensing for Innovative Structures) was established in 1995 to provide civil engineers with smarter ways to build, repair and monitor structures using high-strength, non-corroding, fibre reinforced polymers (FRPs) and fibre optic sensors (FOSs). It was created by the federal Networks of Centres of Excellence (NCE) program and encompasses 14 universities, 30 Project Leaders (principal researchers), 275 researchers, 190 associated organizations, and 45 multidisciplinary demonstration projects. The Administration Centre headquarters for ISIS Canada is at the University of Manitoba.

ISIS Canada Research Network
A250 Agricultural & Civil Engineering Building
96 Dafoe Road • University of Manitoba
Winnipeg, Manitoba R3T 2N2
Ph: 204.474.8506 • Fax: 204.474.7519
e-mail: central@isiscanada.com
www.isiscanada.com
Contact: Dr. Aftab Mufti, President



**Composites
Innovation Centre**

www.compositesinnovation.ca

The Composites Innovation Centre Manitoba Inc. (CIC) is a not-for-profit corporation that is jointly sponsored by private industry and government. Its mandate is to support and stimulate economic growth through innovative research, development and application of composite materials and technologies for manufacturing industries. This is achieved by working directly with industry, on industry sponsored projects that result in a measurable economic benefit to the project participants and the community. Projects are performed in a collaborative partnership with industry, government agencies, and educational establishments. To support these activities, the CIC is funded by and/or has affiliations with several government, research and educational establishments including: Western Economic Diversification Canada, the Province of Manitoba, Destination Winnipeg, National Research Council of Canada, the University of Manitoba, and Red River College.

Composites Innovation Centre
300 - 78 Innovation Drive
Winnipeg, Manitoba R3T 6C2
Ph: 204.262.3400 • Fax: 204.262.3409
e-mail: cbuccivernaus@compositesinnovation.ca
www.compositesinnovation.ca
Contact: Carmela Bucci-Vernaus



www.fyfeco.com

The Fyfe Group is comprised of engineers, designers, material specialists, material manufacturers and project support personnel. Working together, this team provides innovative construction products and technical support to meet the needs of engineers, contractors and owners. Fyfe Co LLC specializes in the Tyfo® Fibrwrap® Advanced Composite Systems for the strengthening, protection and repair of structures. These systems are comprised of carbon, glass and aramid fiber reinforced polymer (FRP) materials.

Fyfe Company also offers other innovative construction products and structural systems. Among these are disc bearings, expansion joints, concrete repair products, blast mitigation and ballistic products.

Fyfe Co. LLC
6310 Nancy Ridge Drive
Suite 103
San Diego, CA 92121
Ph: 858.642.0694
www.fyfeco.com
Contact: Edward Fyfe, President
Scott Arnold, Vice President and Senior Engineer

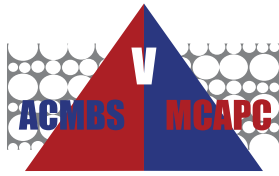

The 5th International Conference on
ADVANCED COMPOSITE MATERIALS IN BRIDGES AND STRUCTURES
MATÉRIAUX COMPOSITES D'AVANT-GARDE POUR PONTS ET CHARPENTES

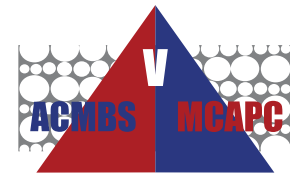

Aslan FRP



www.hughesbros.com
www.vectorgroup.com

Hughes Brothers manufactures FRP Reinforcing under the trade name Aslan FRP. Aslan FRP products include FRP Rebar for reinforcing concrete in corrosive or electrically sensitive environments, GFRP Dowel bars for load transfer between slabs and structural strengthening materials for externally bonded and near surface mount strengthening of existing structures. Vector is the distributor on the Aslan FRP products in Canada. Vector also distributes XMesh high temperature resistant FRP Strengthening materials.

Hughes Brothers
210 N. 13th Street, Seward, NE 68434
Ph: 402.643.2991 • Fax: 402.643.2149
www.hughesbros.com
Contact: Doug Gremel

Vector Group
474 Dovern Court Drive, Winnipeg MB R3Y 1G4
Ph: 204.489.6300 • Fax: 204.489.6033
email: garthf@vectorgroup.com
www.vectorgroup.com
Contact: Garth Fallis



www.pacndt.com

MISTRAS Group Inc. provides complete NDT inspection and testing services as well as customized Structural Health Monitoring (SHM) solutions for partners in academic, government and industry including oil & gas, petrochemical, nuclear, fossil fuel, aerospace and civil infrastructure applications. Physical Acoustics Corporation (PAC), a subsidiary of MISTRAS, designs, develops and manufactures Acoustic Emission (AE) and Automated Ultrasonics instruments and software and Acoustic Emission Sensors (ISO-9001 certified). Our technology gives a better understanding of how composites behave under loads by quickly assessing depth, delaminations, corrosion/erosion, and other internal anomalies in a variety of structures, materials, and surfaces.

Physical Acoustics Corporation
195 Clarksville Road • Princeton Junction, NJ 08550
Ph: 609-716-4000 • Fax: 609-716-0706
Email: sales@pacndt.com • Website: www.pacndt.com
Contact: Richard Gostauts, Infrastructure Group Leader



www.pultrall.com
www.speconst.mb.ca

Founded over 20 years ago, Pultrall has always been a leader in the composite materials market distinguishing itself by its dynamism, its team and the on-going research for improved materials and production methods. Whether you have specific needs for a pultruded profile or you're in an exploratory mode and looking for a different technology that allows for characteristics and performances that usual materials (wood, Plastic, metals) cannot fulfill, your quest for a STRONG and FLEXIBLE partner has come to an end, you're at PULTRALL! One of Pultrall's products is V-ROD composites reinforcement for concrete. V-ROD benefits are: More secure structures, Non-existent corrosion and reduced life cycle cost of 15 to 30%. The advantages of V•ROD rebar are backed by years of testing and actual field results in the most demanding conditions. From now on, limitations will lie with the concrete, and not the reinforcement.

Pultrall Inc.
700 9e rue Nord
Theford Mines, Quebec G6G 6Z5
Ph: 418.335.3202 x: 230 • Fax: 418.335.5117
email: marca.drouin@pultrall.com
www.pultrall.com
Contact: Marc-Andre Drouin, ing. / P.Eng.

Specialty Construction Products Ltd.
77 Paquin Road
Winnipeg, Manitoba R2J 3V9
Ph: 204.661.6738 • Fax: 204.663.4703
email: scp@speconst.mb.ca
www.speconst.mb.ca
Contact: Joe Solomon



www.schoeck-canada.com

Schöck's business is to develop, manufacture and distribute innovative construction elements for applications such as thermal insulation, impact sound insulation and reinforcement technology, being Schöck ComBAR® the latest development in this segment.

Schöck ComBAR® is a new generation high-performance glass fibre reinforced polymer rebar with unique material properties offering new perspectives for diverse applications. It is resistant to corrosion and chemicals, electrically and magnetically non-conductive and thermally insulating.

The corrosion resistance makes it the ideal reinforcement for structures with long durability demand in extremely aggressive environments, such as bridges in Canada. Due to its exceptionally high strength and durability, Schöck ComBAR® provides a superior alternative to any type of reinforcement.

Schöck
Vimbucher Str. 2
76534 Baden-Baden
Germany
email: info@schoeck-canada.com
www.schoeck-canada.com

ACMBS-V ORGANIZING COMMITTEE/ COMITÉ ORGANISATEUR MCAPC-V

Honorary Conference Chair/ Président d'honneur

U. Meier, EMPA

Co-Chairs/ Coprésidents

A.A. Mufti, ISIS Canada and University of Manitoba
K.W. Neale, ISIS Canada and Université de Sherbrooke

Conference Secretariat/ Secrétariat de la Conférence MCAPC-V Secretary General

Kim Archer, ISIS Canada, Canada

Members/ Membres

Baidar Bakht	JMBT Structures Research Inc.
Ruth Eden	Manitoba Infrastructure and Transportation
Mamdouh El-Badry	University of Calgary
Ehab El-Salakawy	University of Manitoba
Garth Fallis	Vector Construction Group
Catalin Gheorghiu	Smith Carter
Mark Green	Queen's University
Andrew Horosko	Manitoba Infrastructure and Transportation
Pierre Labossière	Université de Sherbrooke
Lloyd McGinnis	ISIS Canada Research Network
Sean McKay	Composites Innovation Centre
Dimos Polyzois	University of Manitoba
Ghani Razaqpur	McMaster University
Sami Rizkalla	North Carolina State University
Walter Saltzberg	ISIS Canada Research Network
Joseph Solomon	Specialty Construction Products Ltd.
Doug Stewart	Wardrop Engineering Inc.
Dagmar Svecova	University of Manitoba
Gamil Tadros	SPECO Engineering Ltd.

INTERNATIONAL STEERING COMMITTEE/ COMITÉ SCIENTIFIQUE INTERNATIONAL

Chair/ Président

P. Labossière, Canada

Members/ Membres

A. Abdelrahman, Egypt	S. V. Hoa, Canada	N.G. Shrive, Canada
R. Al-Mahaidi, Australia	L. Hollaway, UK	J. Sim, Korea
C. Bakis, USA	A. Ilki, Turkey	S. Smith, China
M. Baluch, Saudi Arabia	O. B. Isgor, Canada	K. Soudki, Canada
L. Bank, USA	V. Karbhari, USA	G. Sparks, Canada
N. Banthia, Canada	T. Keller, Switzerland	L. Taerwe, Belgium
M. Bartlett, Canada	V. Kodur, USA	B. Taljsten, Denmark
B. Benmokrane, Canada	R. Kotynia, Poland	K. H. Tan, Singapore
L. Bisby, Canada	P. Labossière, Canada	J. G. Teng, China
V. Brown, USA	J. Lees, UK	T. Triantafillou, Greece
C. Burgoyne, UK	S. Lissel, Canada	T. Ueda, Japan
O. Buyukozturk, USA	X. Lu, China	T. Uomoto, Japan
A. Carolin, Sweden	A. Machida, Japan	L. Wegner, Canada
J. F. Chen, UK	B. Massicotte, Canada	G. Wight, Canada
J.J.R. Cheng, Canada	U. Meier, Switzerland	Z. Wu, Japan
M. Cheung, China	A. Mirmiran, USA	L. Ye, China
E. Cosenza, Italy	M. Motavalli, Switzerland	X. L. Zhao, Australia
C. W. Dolan, USA	A.E. Naaman, USA	A. Zureick, USA
R. El-Hacha, Canada	A. Nanni, USA	
E. El-Salakawy, Canada	J. Newhook, Canada	
M. A. Erki, Canada	I. Nishizaki, Japan	
A. Fam, Canada	D. J. Oehlers, Australia	
E. Ferrier, France	Y. Ping, China	
H. GangaRao, USA	M. Polak, Canada	
A. Ghobarah, UAE	K. Sennah, Canada	
N. F. Grace, USA	R. Seracino, USA	
M. Green, Canada	Y. Shao, Canada	
P. Hamelin, France	E. Shehata, Canada	
K. Harries, USA	S. Sheikh, Canada	
T. K. Hassan, Egypt	C. Shield, USA	

Daily Schedule

	Sunday 21 September	Monday 22 September	Tuesday 23 September	Wednesday 24 September
Registration Desk	6:30 - 8:30 pm Registration Desk Open Convention Foyer	8:00 am - 4:00 pm Registration Desk Open Convention Foyer	8:00 am - 4:00 pm Registration Desk Open Convention Foyer	8:00 am - NOON Registration Desk Open Convention Foyer
Keynote Presentations		8:30 am - 10:00 am Welcome Keynote Presentation: <i>Delivering Successful Innovation: Key Challenges in Research and Practice</i> S.R. Denton, Parsons Brinckerhoff's, Director of Bridge and Structural Engineering, Bath, United Kingdom Midway Ballroom	11:00 am - 12:00 pm Tribute to Professor Urs Meier, Honorary Chair of the ACMB-S-V Conference Keynote Presentation: <i>Sustainable Bridges - A European Integrated Research Project - Background, Overview and Results</i> B. Täljsten, Denmark Technical University, Lyngby, Denmark, & L. Elfgren, Luleå University of Technology, Luleå, Sweden Midway Ballroom	1:30 pm - 4:00 pm Keynote Presentation: <i>A Burning Issue for FRP: Structural Performance in Fire</i> M. Green, Queen's University, Kingston, Canada Young Researchers' Forum Closing Midway Ballroom
Technical Conference		Session M-AM-2-A: Material Properties Session M-AM-2-B: Innovative Structural Systems with FRPs Session M-AM-2-C: Near-Surface Mounted FRPs Session M-PM-1-A: FRP in RC beams and columns Session M-PM-1-B: Practical applications & structural case histories Session M-PM-1-C: Advanced design methods and modelling Session M-PM-2-A: Material properties Session M-PM-2-B: Innovative structural systems with FRPs Session M-PM-2-C: Near-surface mounted FRPs	Session T-AM-1-A: FRP in RC beams and columns Session T-AM-1-B: Innovative Structural Systems with FRPs Session T-AM-1-C: Structural monitoring methods & their applications Session T-PM-1-A: Material properties Session T-PM-1-B: Large scale testing Session T-PM-1-C: Prestressed concrete and prestressing with FRPs Session T-PM-2-A: FRP in RC beams and columns Session T-PM-2-B: Innovative structural systems with FRPs Session T-PM-2-C: Advanced design methods and modelling	Session W-AM-1-A: RC slabs and steel-free decks Session W-AM-1-B: Interface, bond and anchors Session W-AM-1-C: Joints and seismic loads Session W-AM-2-A: Material properties Session W-AM-2-B: Innovative structural systems with FRPs Session W-AM-2-C: Prestressed concrete and prestressing with FRPs
Special Events	6:30-9:30 pm Welcoming Reception East Ballroom	6:30 -10:00 pm ACMB-S-V Social Evening Royal Crown Revolving Restaurant	6:30-10:00 pm Reception & Banquet West Ballroom	

Sunday

21 September

6:30 -8:30 pm **Registration** West Ballroom

6:30 -9:30 pm **Welcoming Reception** West Ballroom

Mezzanine Level

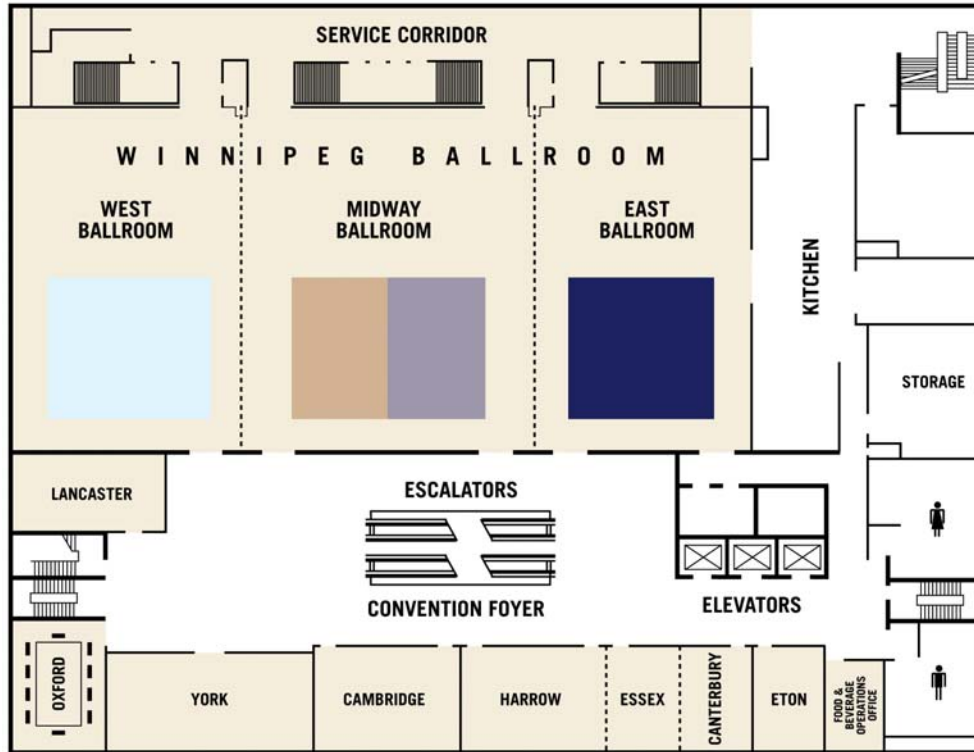

Lobby Level

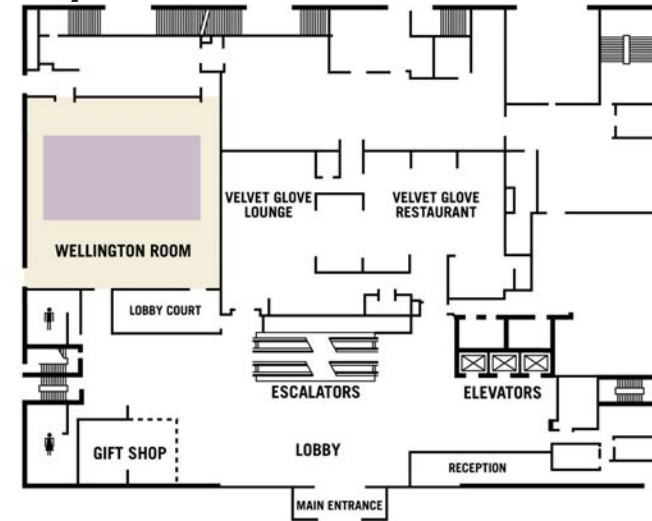

Concourse Level

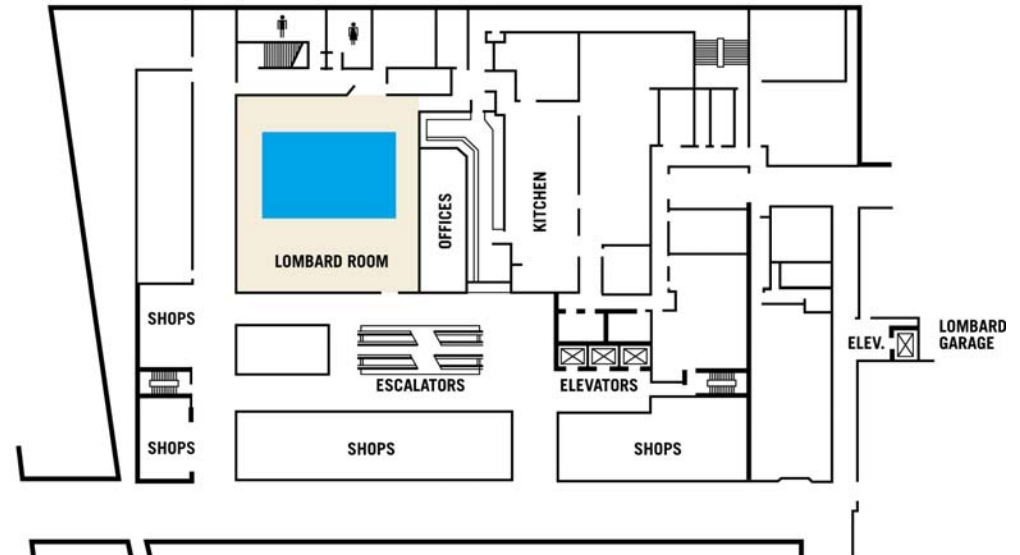

Monday

22 September

8:30 -10:00 am

Opening Session Midway Ballroom

Chair: Pierre Labossière

Welcome

Conference Co-Chairs, A.A. Mufti and K.W. Neale
 Government of Manitoba Minister of Transportation and Infrastructure, Ron Lemieux
 University of Manitoba V.P. Research, Dr. Joanne Keselman

Keynote Presentation: Delivering Successful Innovation: Key Challenges in Research and Practice
 - S.R. Denton, Parsons Brinckerhoff's, Director of Bridge and Structural Engineering, Bath, United Kingdom

10:00-10:30 am

Coffee Break

East Ballroom

	Session M-AM-2-A: Material Properties Chair: S. Sheikh Wellington Room	Session M-AM-2-B: Innovative Structural Systems with FRPs Chair: T. Ibell West Ballroom	Session M-AM-2-C: Near-Surface Mounted FRPs Chair: K. Harries Midway Ballroom
10:30-10:50 am	SIM test results for aramid fibres - I.P. Giannopoulos & C.J. Burgoyne Page No. 105	Function-integrated GFRP sandwich roof structure - T. Keller & C. Haas Page No. 59	Experimental and numerical investigation of RC beams strengthened in bending with near-surface-mounted CFRP bars - S.M. Soliman, E. El-Salakawy, B. Benmokrane & H. Abdel Baky Page No. 83
10:50-11:10 am	Corrosion problems in bridge construction - Alternative solutions using glass fibre reinforcement - C. Witt & B. Jütte Page No. 106	TSCB - Twin Shape Composed Beam - W. Amaro, E. Cadoni, L. Diviani, F. Brogginì & A. Pedretti Page No. 60	Experimental study of bond behavior between NSM FRP and concrete - R. Kotynia Page No. 91
11:10-11:30 am	Performance of jute/epoxy curved laminate subjected to flexural tensile loading - A.A. Khalid Page No. 107	A composite housing system for use in northern communities of Canada - D. Polyzois & D. Philopoulos Page No. 61	Preliminary investigation into the bond of prestressed near surface mounted CFRP rods in concrete - N. Wahab, K.A. Soudki & T. Topper Page No. 85
11:30-11:50 am	Bond characteristics of micro-composite multi structural formable steel reinforcement - J.M.I. Soliman, T.K. Hassan, A. S.A. Fayad & S.H. Rizkalla Page No. 108	Development of latticed structures using advanced composite materials - A. Ochonski, D. Polyzois & I.G. Raftoyiannis Page No. 61	Flexural behaviour of partially bonded near-surface-mounted CFRP strengthened concrete T-beams - H.T. Choi, J.S. West & K.A. Soudki Page No. 86
11:50-12:00 pm	SESSION WRAP-UP	SESSION WRAP-UP	SESSION WRAP-UP

12:00-1:30 pm

Lunch sponsored by Halsall Associated Ltd.

Lombard Room

	Session M-PM-1-A: FRP in RC beams and columns Chair: S. Rizkalla Wellington Room	Session M-PM-1-B: Practical applications & structural case histories Chair: M.A. Erki Midway Ballroom	Session M-PM-1-C: Advanced design methods and modelling Chair: R. Seracino West Ballroom
1:30-1:50 pm	Design of concrete structures reinforced with FRP bars: A critical review of codes and standards - J.F. Davalos, Y. Chen & I. Ray <i>Page No. 23</i>	Innovative repair and monitoring of an unbonded, post-tensioned concrete building using CFRP tendons - L. Amato, E. Murison, M. Green, C. MacDougall, S. Trepanier & G. Fallis <i>Page No. 141</i>	Ductility design of FRP retrofitted RC structures - D.J. Oehlers, M. Ali M.S., M. Haskett & M.C. Griffith <i>Page No. 11</i>
1:50-2:10 pm	Repair and strengthening of severely damaged concrete beams with externally bonded CFRP - D. Byrne & T. Tikka <i>Page No. 30</i>	Pultruded GFRP posts for railway noise barriers - F. Riebel, T. Vallée & T. Keller <i>Page No. 142</i>	Flexural stiffness modelling of RC slab strengthened by externally bonded FRP - L. Michel, E. Ferrier & P. Hamelin <i>Page No. 12</i>
2:10-2:30 pm	Shear strength of large-size concrete beams reinforced with glass FRP bars - S. Steiner, A.K. El-Sayed, B. Benmokrane, F. Matta & A. Nanni <i>Page No. 32</i>	Field application on strengthening two-way reinforced concrete floor slab using externally bonded SRP sheets - R. El-Hacha & M. Gaafar <i>Page No. 143</i>	Numerical aspects concerning the accuracy of finite element simulations of concrete beams strengthened in flexure using FRP sheets - H. Abdel Baky, U.A. Ebead & K.W. Neale <i>Page No. 13</i>
2:30-2:50 pm	Strength of reinforced concrete beams rehabilitated for flexure using externally bonded FRP - S.R. Salib & G. Abdel-sayed <i>Page No. 29</i>	Parametric optimization of the strengthening of gulfport 230kV transmission structures with glass fibre reinforced polymer (GFRP) wrap - A. Shahi, J.S. West & M.D. Pandey <i>Page No. 145</i>	Comparison of interface elements to simulate the interfacial behaviour of FRP shear-strengthened beams - A. Godat, P. Labossière & K.W. Neale <i>Page No. 19</i>
2:50-3:00 pm	SESSION WRAP-UP	SESSION WRAP-UP	SESSION WRAP-UP
3:00 - 3:30 pm	Coffee Break East Ballroom		

Monday

22 September

Session M-PM-2-A: Material properties
Chair: C. Burgoyne
 Wellington Room

Session M-PM-2-B: Innovative structural systems with FRPs
Chair: P. Hamelin
 Midway Ballroom

Session M-PM-2-C: Near-surface mounted FRPs
Chair: Y.J. Kim
 West Ballroom

3:30-3:50 pm	Parametric study of temperature distribution in CFRP strengthened beam-slab assembly under fire conditions - Y. Liu & J. Jia Page No. 114	Development of an FRP deployable bridge - A. Xie, R.G. Wight & M.A. Erki Page No. 63	Study of RC beams strengthened in flexure with near surface mounted CFRP strips by numerical and analytical modeling - M.Z. Kabir & H.Y. Omran Page No. 87
3:50- 4:10 pm	Durability of mechanical properties of pultruded GFRP materials under several deterioration test conditions - I. Nishizaki, T. Tomiyama & Y. Kato Page No. 113	Static and dynamic behavior of multi-cell jointed GFRP wind turbine towers - D. Polyzois, I.G. Raftoyiannis, N. Ungkurapinan & A. Ochonski Page No. 64	Anchorage and bond behaviour of near surface mounted carbon fibre reinforced polymer bars - W.K.K.G. Perera, T.J. Ibell, A.P. Darby & S.R. Denton Page No. 88
4:10-4:30 pm	The effect of elevated temperatures on half and fully CFRP wrapped concrete cylinders - C.A. Issa Page No. 115	Development of GFRP stay-in-place open structural form system for concrete girders - H. Honickman & A. Fam Page No. 65	Monotonic tests and modeling for NSM prestressed strengthened beams - M. Badawi & K. Soudki Page No. 89
4:30-4:50 pm	Comparative performance of externally-bonded and near surface mounted FRP strengthening systems at high temperatures - L.A. Bisby, P.J. Burke & M.F. Green Page No. 116	Use of pultruded FRP I-sections in composite concrete sections - A.M. Fadel & G.M. Elmahdy Page No. 66	Durability of various NSM FRP strengthening systems for RC flexural members - M. Derias, R. El-Hacha & S. Rizkalla Page No. 90
4:50-5:10 pm	Behaviour of CFRP-strengthened cantilever hollow-core panels - M.K. Rahman, I.A. Mahmoud & M.H. Baluch Page No. 100	Innovations in GFRP bridge deck systems - E. Shehata, A. Fam, S. Rizkalla & A. Mufti Page No. 70	Shear strengthening of reinforced concrete beams with NSM CFRP systems - R. Kotynia Page No. 92
5:10-5:15 pm	SESSION WRAP-UP	SESSION WRAP-UP	SESSION WRAP-UP

6:30 -10:30 pm **ACMBS-V Social Evening** Royal Crown Revolving Restaurant

(Meet in the Hotel's front lobby at 6:00 pm.
 Walking Maps or City Bus tickets available.)

Tuesday

23 September

	Session T-AM-1-A: FRP in RC beams and columns Chair: T. Ueda Midway Ballroom	Session T-AM-1-B: Innovative Structural Systems with FRPs Chair: D. Polyzois West Ballroom	Session T-AM-1-C: Structural monitoring methods & their applications Chair: A. Fam Wellington Room
8:45-9:05 am	Strengthening of structures with changes in section properties using externally bonded FRP - A.P. Darby, T.J. Ibell & S.R. Denton Page No. 31	Direct load transfer in hybrid FRP-concrete sandwich structure for bridge decks - E. Schaumann, T. Keller & T. Vallée Page No. 68	Considering the effect of uncertainty in the existing structure on the reliability of FRP repair schemes - R. Atadero Page No. 25
9:05-9:25 am	Shear strength of RC beams reinforced with FRP stirrups - E.A. Ahmed, E. El-Salakawy & B. Benmokrane Page No. 33	Effective bridge engineering design guidelines for FRP honeycomb sandwich decks - J.F. Davalos, B. Zou & J.D. Plunkett Page No. 69	Measuring performance of concrete bridges strengthened with FRP-structural systems - K.C. Crawford Page No. 135
9:25-9:45 am	Effective moment of inertia for concrete beams reinforced with fiber reinforced polymer (FRP) - H. Vogel & D. Svecova Page No. 34	Finite element analysis of hybrid FRP-concrete composite girders - A. Elmahdy, N. Shrive & R. El-Hacha Page No. 67	Structural health monitoring of CFRP reinforced concrete one way slabs by acoustic emission - S. Degala, K.N. Ramanathan, P. Rizzo & K.A. Harries Page No. 136
9:45-10:05 am	Numerical investigation of failure localization and stress concentrations in FRP wrapped concrete cylinders - M. Tabbara & G. Karam Page No. 39	Addressing uncertainty and complexity when designing for sustainability and life cycle costs - G. Sparks, K. Kostuk, P. Christensen & G. Tadros Page No. 24	The use of random decrement technique for health monitoring of structures - A.A. Elshafey, M.R. Haddara & H. Marzouk Page No. 137
10:05-10:25 am	Evaluation of damage index factor for short RC columns retrofitted by externally bonded CFRP - G. Promis, E. Ferrier & P. Hamelin Page No. 40	Crashworthy design of concrete highway bridge railing reinforced with advanced composite bars - F. Matta Page No. 71	Quantitative monitoring of damage progression in FRP strengthened bridge systems through modal testing - V.M. Karbhari & K.K. Ghosh Page No. 138
10:25-10:30 am	SESSION WRAP-UP	SESSION WRAP-UP	SESSION WRAP-UP

10:30-11:00 am **Coffee Break** East Ballroom

11:00-12:00 pm **General Session** Midway Ballroom

Chair: Aftab Mufti

Tribute to Professor Urs Meier, Honorary Chair of the ACMBS-V Conference

Keynote Presentation: Sustainable Bridges - A European Integrated Research Project - Background, Overview and Results
B. Täljsten, Denmark Technical University, Lyngby, Denmark, & L. Elfgren, Luleå University of Technology, Luleå, Sweden

12:00-1:30 pm **Lunch** Lombard Room

	Session T-PM-1-A: Material properties Chair: G. Wight Midway Ballroom	Session T-PM-1-B: Large scale testing Chair: R. Kotynia Wellington Room	Session T-PM-1-C: Prestressed concrete and prestressing with FRPs Chair: A. Ilki West Ballroom
1:30-1:50 pm	Performance of FRP for use in concrete structures under freeze-thaw cycles and sustained load - S. Tam & S.A. Sheikh <i>Page No. 109</i>	Finite element modelling of a composite cladding wall panel under simulated wind pressure - T. Sharaf & A. Fam <i>Page No. 129</i>	Flexural strengthening of steel-concrete composite girders using prestressed FRP - R. El-Hacha & M. Ali <i>Page No. 95</i>
1:50-2:10 pm	Thermal limits for external bonding repair method on structural surfaces exposed to the environment - L.F.P. Juvandes, P. Costeira Silva, M. Alpalhão, J. Moreira & M. Silva <i>Page No. 110</i>	Rapid construction and rehabilitation of box-girder decks using FRP stay-in-place structural formwork - A. Pridmore & V.M. Karbhari <i>Page No. 130</i>	Effect of type of FRP tendon on prestress losses - G.M. Elmahdy & A.M. Fadel <i>Page No. 96</i>
2:10-2:30 pm	Water uptake detection in concrete structures strengthened with fibre reinforced polymers - A.A. Nassr & W.W. El-Dakhkhni <i>Page No. 111</i>	Performance evaluation and FRP repair of concrete T-beam bridges - J.F. Davalos, C. Lin, I. Ray, W. Sasher, G. Parish & K.E. Barth <i>Page No. 131</i>	Evaluation of deformability index for concrete beams prestressed with aramid fiber reinforced polymer (AFRP) tendons - Y.J. Kim <i>Page No. 97</i>
2:30-2:50 pm	Adhesion evaluation between CFRP-concrete after highthermic cycles - M. Kliem, L.F.P. Juvandes, J. Magalhães, F. Cardoso & P. Costeira <i>Page No. 112</i>	Emergency repair of damaged bridge columns using fiber reinforced polymer (FRP) materials - A. Vosooghi, J. Gutierrez, M.S. Saiidi, S.F. Arnold & J. Khabra <i>Page No. 132</i>	Integrated strengthening of structures with bonded prestressed FRP reinforcements - Z. Wu, K. Iwashita & X. Wang <i>Page No. 98</i>
2:50-3:00 pm	SESSION WRAP-UP	SESSION WRAP-UP	SESSION WRAP-UP
3:00 - 3:30 pm	Coffee Break East Ballroom		

Tuesday

23 September

	Session T-PM-2-A: FRP in RC beams and columns Chair: B. Benmokrane Wellington Room	Session T-PM-2-B: Innovative structural systems with FRPs Chair: R. El-Hacha Midway Ballroom	Session T-PM-2-C: Advanced design methods and modelling Chair: D. Oehlers West Ballroom
3:30 - 3:50 pm	Reliability analysis of RC columns strengthened with CFRP laminates - Z. He, D. Zhang & X. Li <i>Page No. 41</i>	FRP composite reinforcements for improving shear performance of glued-laminated timbers - T.R. Gentry, J.D. Schwartz, S.M. Hensey & B.Y.C. Chang <i>Page No. 72</i>	Analytical model for plate-end debonding of near-surface mounted FRP strips in concrete flexural members - D. Vásquez & R. Seracino <i>Page No. 16</i>
3:50 - 4:10 pm	Strength of reinforced concrete filled FRP tube slender columns - H. Mohamed, H. El Zefzafy & R. Masmoudi <i>Page No. 42</i>	Mechanical performance of new hybrid glulam beams with FRPs - E. Ferrier, M. Behloul, G. Chanvillard, P. Labossière & K.W. Neale <i>Page No. 73</i>	Comparison of finite element approaches for modeling unbonded FRP shear reinforcement - N.A. Hoult & J.M. Lees <i>Page No. 17</i>
4:10 - 4:30 pm	Numerical investigation of the behaviour of FRP-wrapped RC slender columns under eccentric loading - M.Z. Kabir & A. Mansouri <i>Page No. 43</i>	Performance of an externally bonded CFRP system for strengthening steel structures - M. Dawood, M. Guddati & S. Rizkalla <i>Page No. 74</i>	Fully coupled closed form solution for interfacial stresses in slender plated structures - P. Coudor, J.F. Destrebecq & A. Beakou <i>Page No. 18</i>
4:30 - 4:50 pm	Comparison of the circular and rectangular RC bridge piers retrofitted using fiber-reinforced polymer (FRP) jacket - M.A. Shayanfar & M.S. Zarrabian <i>Page No. 44</i>	Analytical model for predicting the monotonic response of damaged steel beams repaired by ultra-high modulus CFRP - A. Fam & C. MacDougall <i>Page No. 75</i>	Numerical study for the parameters affecting CFRP plate strengthening of full scale RC beam - A.I.M. Al-Janabi, S.A. Ahmed & A.R. Safi <i>Page No. 15</i>
4:50 - 5:10 pm	A preliminary investigation of the use of CFRP for internal or external reinforcement of RC beams in Bulgaria - E. Abdulahad, D. Panichkov & F. Rangelova <i>Page No. 35</i>	Flexural behaviour of a polymer encased concrete wall system - K. Soudki, A. Rteil & D. Richardson <i>Page No. 79</i>	Numerical investigation on shear strengthening of two-way slab-column connection with FRP strips and rods under cyclic and monotonic loading - M.Z. Kabir & H. Ghaednid <i>Page No. 20</i>
5:10 - 5:15 pm	SESSION WRAP-UP	SESSION WRAP-UP	SESSION WRAP-UP
6:30 - 10:00 pm	Reception & Banquet sponsored by ISIS Canada		Midway Ballroom

Wednesday

24 September

	Session W-AM-1-A: RC slabs and steel-free decks Chair: E. Ferrier West Ballroom	Session W-AM-1-B: Interface, bond and anchors Chair: K. Soudki Midway Ballroom	Session W-AM-1-C: Joints and seismic loads Chair: H. Marzouk Wellington Room
8:30 - 8:50 am	Numerical analysis of punching failure mechanism and debonding of slabs strengthened with externally bonded FRP - A.S. Farghaly & T. Ueda <i>Page No. 53</i>	Shear strength and behaviour of FRP spike anchors in FRP-to-concrete joint assemblies - S.T. Smith & S.J. Kim <i>Page No. 123</i>	Seismic retrofit of beam-column joints with FRP sheets - A. Ilki, I. Bedirhanoglu & N. Kumbasar <i>Page No. 47</i>
8:50 - 9:10 am	Effect of flexural reinforcement on punching shear resistance of steel and FRP-reinforced slabs - D.D. Theodorakopoulos & R.N. Swamy <i>Page No. 54</i>	Analysis of mechanically fastened FRP-strengthened concrete structures - W. Elsayed, U. Ebead & K.W. Neale <i>Page No. 124</i>	Shear strengthening of beam-column joints using steel-reinforced polymers - M. Elbadry & R. Izi <i>Page No. 50</i>
9:10 - 9:30 am	Effects of confinement from lateral restraints in steel-free deck models under static loading - M.R. Alam, G. Mediwake, A.A. Mufti & N. Rattanawangcharoen <i>Page No. 55</i>	Testing and finite element analysis of delamination in RC beams strengthened in bending by FRP laminate - A.A.B. Mostafa & A.G. Razaqpu <i>Page No. 125</i>	Seismic rehabilitation of RC beam-column corner joints using CFRP sheet - S.H. Alsayed, Y.A. Al-Salloum, T.H. Almusallam & N.A. Siddiqui <i>Page No. 48</i>
9:30 - 9:50 am	Degradation of GFRP-reinforced concrete bridge deck slabs subjected to lifetime-equivalent accelerated fatigue loading - A. El-Ragaby, E. El-Salakawy & B. Benmokrane <i>Page No. 56</i>	SEM analysis of CFRP strand for use in high capacity permanent ground anchors - M. Sentry, R. Al-Mahaidi, A. Bouazza, F. Collins, D. Loidl, & L. Carrigan <i>Page No. 126</i>	Performance of FRP-repaired seismically deficient exterior RC joint versus ACI-based designed joint - Y.A. Al-Salloum, T.H. Almusallam, S.H. Alsayed & N.A. Siddiqui <i>Page No. 49</i>
9:50 - 10:00 am	SESSION WRAP-UP	SESSION WRAP-UP	SESSION WRAP-UP
10:00-10:30 pm	Coffee Break East Ballroom		

Wednesday

24 September

	Session W-AM-2-A: Material properties Chair: T. K. Hassan Midway Ballroom	Session W-AM-2-B: Innovative structural systems with FRPs Chair: G. Razaqpur Wellington Room	Session W-AM-2-C: Prestressed concrete and prestressing with FRPs Chair: E. Ferrier West Ballroom
10:30-10:50 am	Composite rebars in RC members in case of fire - A. Weber, C. Witt & A. Nadjai Page No. 117	Tensile response of GFRP-reinforced high strength concrete panels - T.B. Sabrah, H. Marzouk & A. Hussein Page No. 77	Classical laminate theory and failure criteria for prestressed CFRP sheets for strengthening prestressed concrete beams - Y.J. Kim, M.F. Green & R.G. Wight Page No. 99
10:50-11:10 am	Effect of corrosion on CFRP confined bond under repeated loading - A. Rteil, K. Soudki & T. Topper Page No. 119	Ductility and shear capacity of reinforced concrete members retrofitted with continuous fiber rope - T. Shimomura, S. Kawana & Y. Tanaka Page No. 78	Innovative system to strengthen reinforced concrete beam with prestressed NSM FRP technique - M.A. Gaafar & R. El-Hacha Page No. 84
11:10-11:30 am	Evaluation of properties of continuous fibre rope - K. Sekijima & J. Izumo Page No. 119	Deflection-based design of composite sheet pile walls - Y. Shao & Z. Bdeir Page No. 80	Flexural behaviour of precast, prestressed hollow-core concrete slabs strengthened by CFRP - I.A. Mahmood, M.K. Rahman & M.H. Baluch Page No. 101
11:30-11:50 am	Study on the durability of adhesive properties of continuous fiber sheet reinforcement with concrete - Y. Kato, T. Tomiyama & I. Nishizaki Page No. 120	Experimental and numerical investigation of in-plane shear behaviour of CFRP-strengthened masonry walls with door openings - Q. Gu, W. Zhang, B. Peng & S. Peng Page No. 76	
11:50-12:00 pm	SESSION WRAP-UP	SESSION WRAP-UP	SESSION WRAP-UP

12:00 - 1:30 pm **Lunch** Lombard Room

1:30 -4:00 pm

General Session and Closing Midway Ballroom
Chair: K.W. Neale

Keynote Presentation: A Burning Issue for FRP: Structural Performance in Fire
- M. Green, Queen's University, Kingston, Canada

Young Researchers' Forum
- L. Bisby, J. Lees, S.T. Smith

Announcement of ACMBS-VI and Closing of ACMBS-V